

Interactive Polling



Interactive Polling

- The intent of interactive polling is to gauge public interests and support for multiple planning drivers and strategies within the project
- Feedback provided is anonymous
- We will allow approximately 20-30 seconds for participants to respond
- Input will be analyzed and taken into consideration as the project design progresses, but do not constitute formalized project directives
- If you would like to provide additional information or alternative poll responses, please submit your input to [**PDOP.org/rehmparkplan/**](https://pdop.org/rehmparkplan/)

Topic 1

Existing Rehm Pool Opinions

Interactive Polling

1. What do you enjoy most about Rehm Pool?

- Community Gathering Space
- Zero-depth entry pool
- Waterslides
- Spray pad
- 50-meter pool
- Other

Interactive Polling

3. What aspect of Rehm Pool do you find the most challenging?

- Age and quality of bathhouse & pools
- Variety of aquatic amenities & activities
- Size of pool or available pool area
- Amount of deck space / dry area
- Other

Interactive Polling

5. What areas of Rehm Pool would you like to see improved?

- Increased deck space
- More shade canopies
- Aquatic activities for Seniors
- Aquatic activities for Teens
- Aquatic activities for younger children
- Improved restrooms and changing facilities
- Sustainability Features
- Other

** Select multiple if desired*

Topic 2

Potential Amenities

Interactive Polling

7. Please rank the aquatic improvements in order of preference

- Spray Pad
- Current channel / vortex
- Water Basketball / Volleyball
- Crossing Activities
- Waterslides

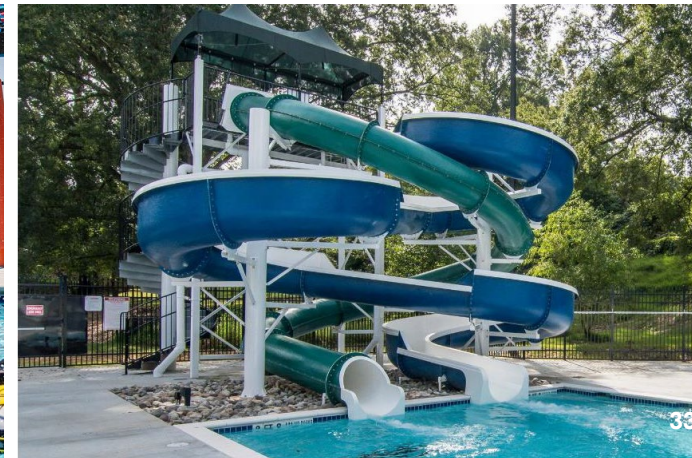

Topic 3

Potential Concepts

Interactive Polling

8. Please rank the amenity groups in order of preference

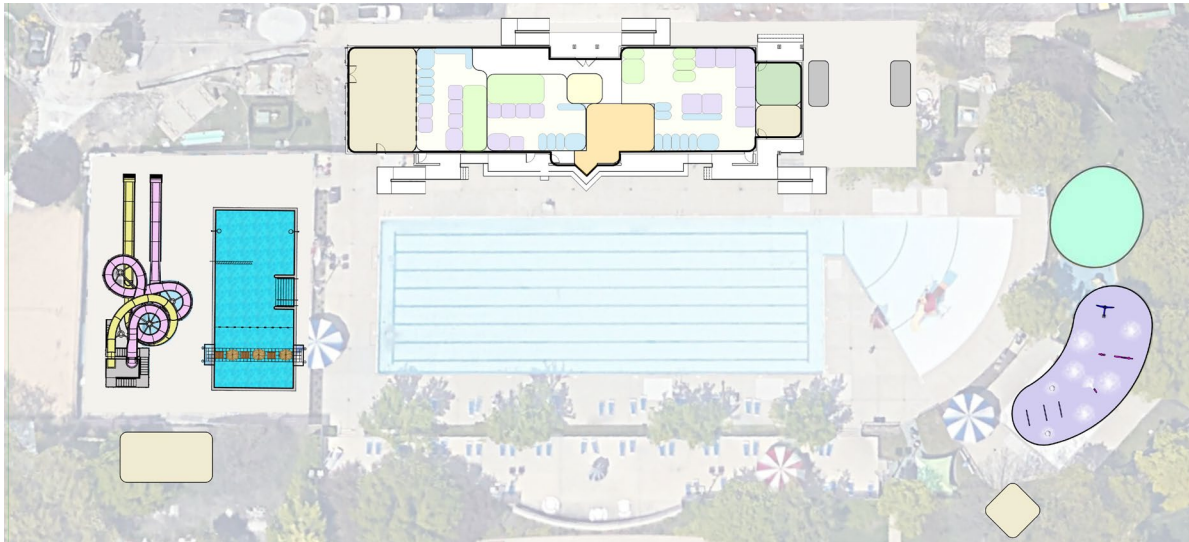

Pool 1a

Waterslides with deck runouts and a pool with crossing activity and basketball

Pool 1b

Spray pad and dry playground

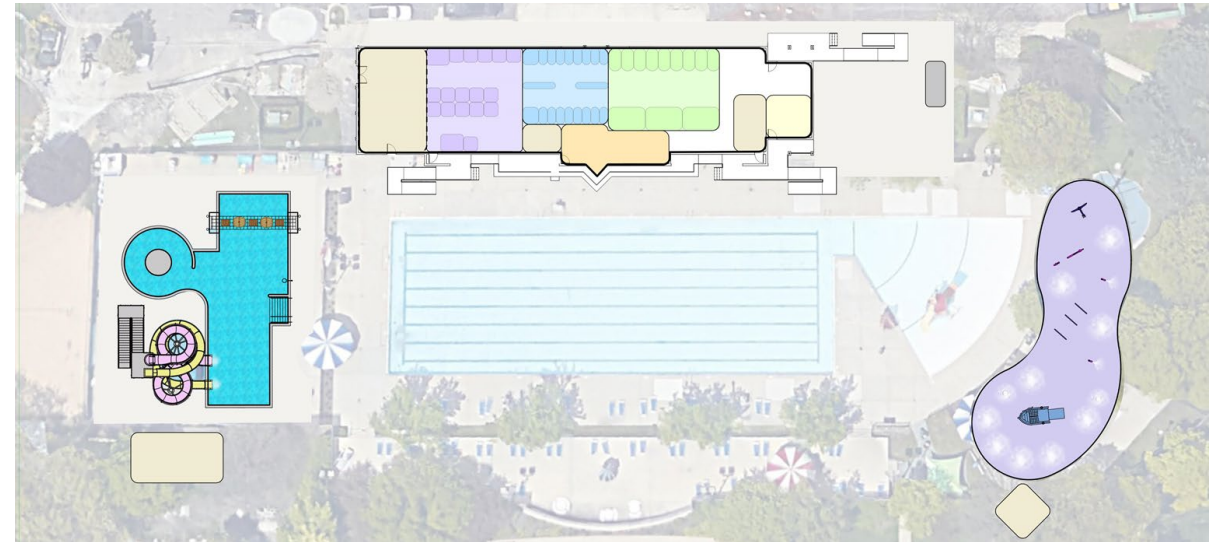

Pool 2a

Pool with waterslides, crossing activity, and current channel

Pool 2b

Large spray pad



Interactive Polling

9. Do you prefer mens, womens, & family locker room facilities or a single all-inclusive locker room?

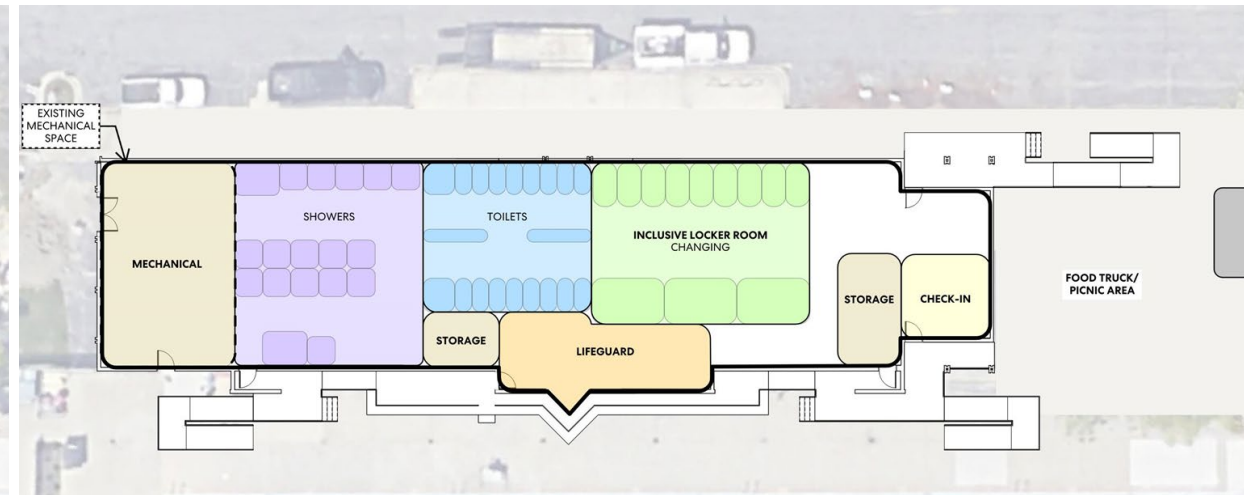
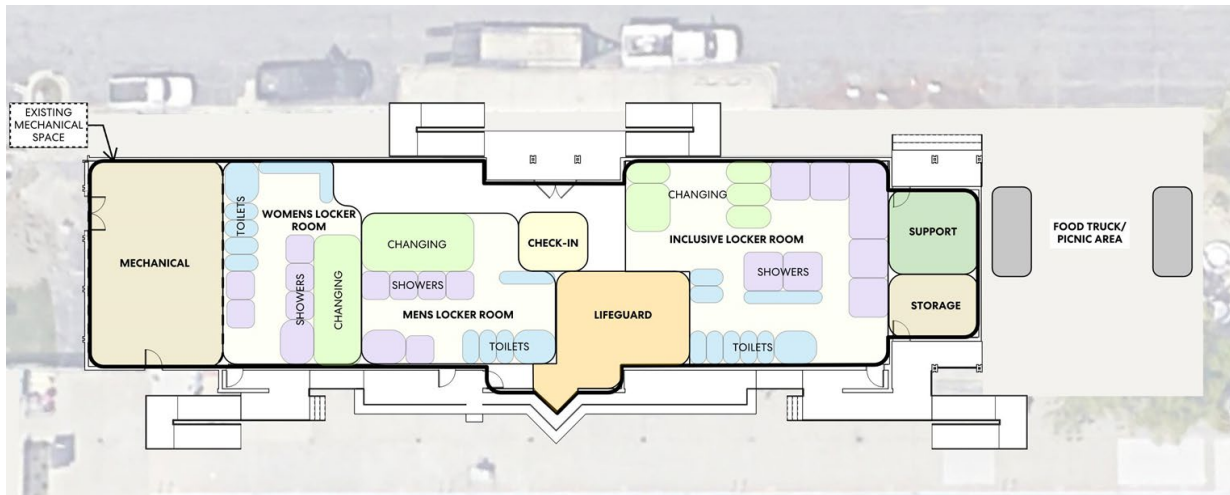

- Prefer separate facilities
- Prefer inclusive facilities
- Neutral



Interactive Polling

10. Do you prefer an entry to the bathhouse at the center of the building or the east side of the building?

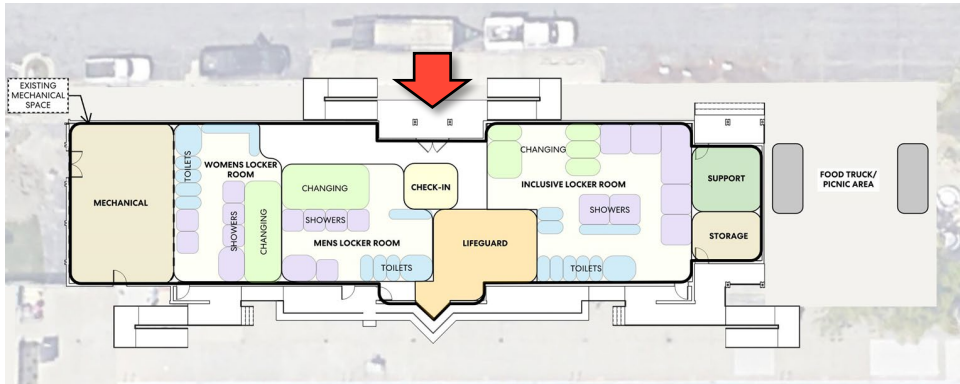

Central Entry

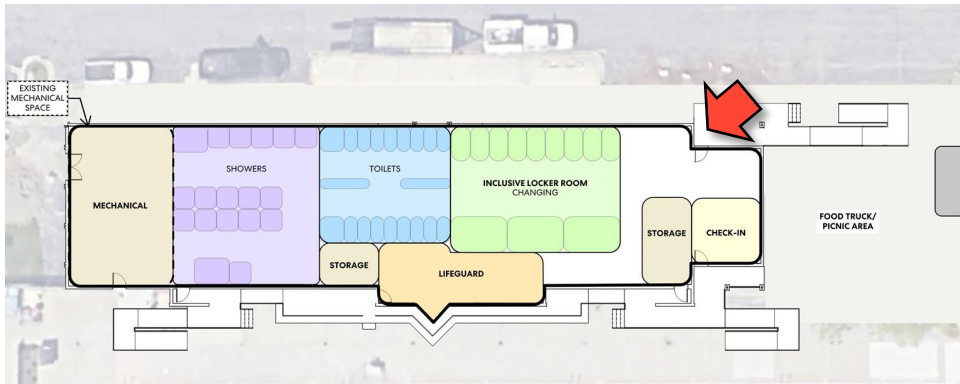

East Entry

- Prefer central entry
- Prefer east entry
- Neutral



Interactive Polling

11. How strongly would you prefer the Park District maintain the existing bathhouse building?

- Strongly preferred
- Preferred
- Neutral
- Not preferred
- Strongly not preferred

